

FITTING INSTRUCTIONS

MECHANICAL TIMER, 24 HOUR, 5V

This Timer is suitable for installation on the **KESTON COMBI C RANGE**



ALWAYS switch off and disconnect the electricity supply to the appliance before installing the Receiver/Programmer. Merely switching the boiler OFF/SUMMER/WINTER switch to 'OFF' will still leave a live feed to the boiler.

Keston Mechanical Timer

Unclassified when used in isolation. Class II when used in conjunction with Weather Compensation.
Contribution to Seasonal Space Heating Energy Efficiency - 0% (Unclassified), 2% (Class II)

INSTALLING THE MECHANICAL TIMER

1. Ease out the blanking plate using screwdriver slot situated at the bottom centre of the plate and discard.
2. Remove the link wire plug and discard.
3. Connect the electrical plug as shown.
4. Locate and push the mechanical timer assembly into the control box housing.
5. Power up the boiler and check for correct operation.
6. To program, refer to the user guide supplied with the kit

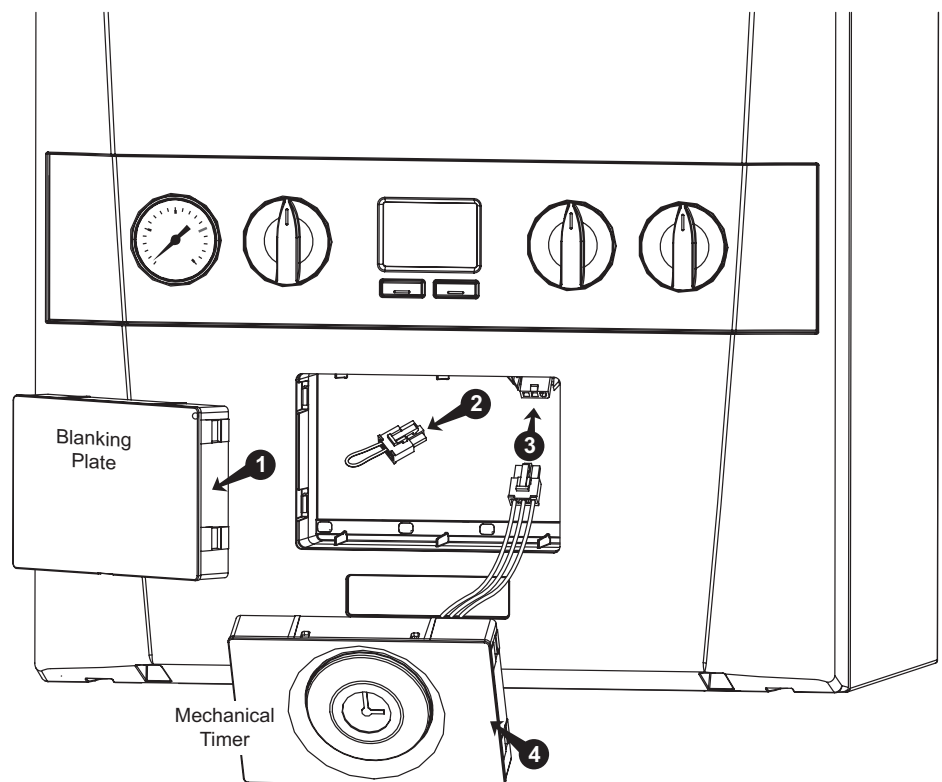

WEEE DIRECTIVE 2012/19/EC

Waste Electrical and Electronic Equipment Directive

- At the end of the product life, dispose of the packaging and product in a corresponding recycling centre.
- Do not dispose of the unit with the usual domestic refuse.
- Do not burn the product.
- Remove the batteries.
- Dispose of the batteries according to the local statutory requirements and not with the usual domestic refuse.

Keston Heating, PO Box 103, National Avenue, Kingston Upon Hull, HU5 4JN
Tel. +44 (0) 1482 443005 Fax. +44 (0) 1482 467133. www.keston.co.uk

July 2016 UIN 216275 A01



Keston pursues a policy of continuing improvement in the design and performance of its products. The right is therefore reserved to vary specification without notice.